

Front Adjustable Track Bar

Dodge Ram | 2013-2025 3500 4WD Pickup | 2014-2026 2500 4WD Pickup

Part #: 122324 Rev. 052626



491 W. Garfield Ave., Coldwater, MI 49036 • Phone: 517-279-2135

Web: www.bds-suspension.com • E-mail: tech-bds@ridefox.com

SAFETY WARNING

BDS Suspension Co. recommends this system be installed by a professional technician. In addition to these instructions, professional knowledge of disassembly/ reassembly procedures and post installation checks must be known.

INSTALLATION INSTRUCTIONS

1. Park vehicle on clean flat and level surface. Block the rear wheels for safety.
2. Remove the factory trackbar, retain hardware for installation of new trackbar.
3. Adjust trackbar length to stock length for stock height applications and lifts with track bar bracket, adjust to 39-1/8" for 3" of lift.
4. Install trackbar with the gussets on the 'bottom' side with factory hardware, apply thread locker to the threads.
5. Adjust length of trackbar to center axle.
6. Tighten trackbar axle hardware to 285 ft-lbs and frame hardware to 74 ft-lbs plus 160deg of rotation
7. Install the 2 - 3/8" socket head pinch bolts and nylock nuts and torque to 40 ft-lbs.
8. Adjust drag link length to get the steering wheel to be centered. Ensure there is proper engagement of threads. Do not drive the vehicle for extended periods of time with the steering wheel crooked.
9. Recheck all hardware, check again at regular maintenance intervals.

Bill of Materials

Part #	Qty	Description
A490	1	Forged Front Track Bar w/Bushing
BP1066	1	Bolt Pack
	2	3/8" -16 x 1-1/4" Socket Head Bolt
	2	3/8"-16 Nylock Nut
342701	1	Thread Locker

05214
2014-2022 RAM 2500/3500
FRONT TRACK BAR RUBBER BUSHING
QTY REQ'D (2)

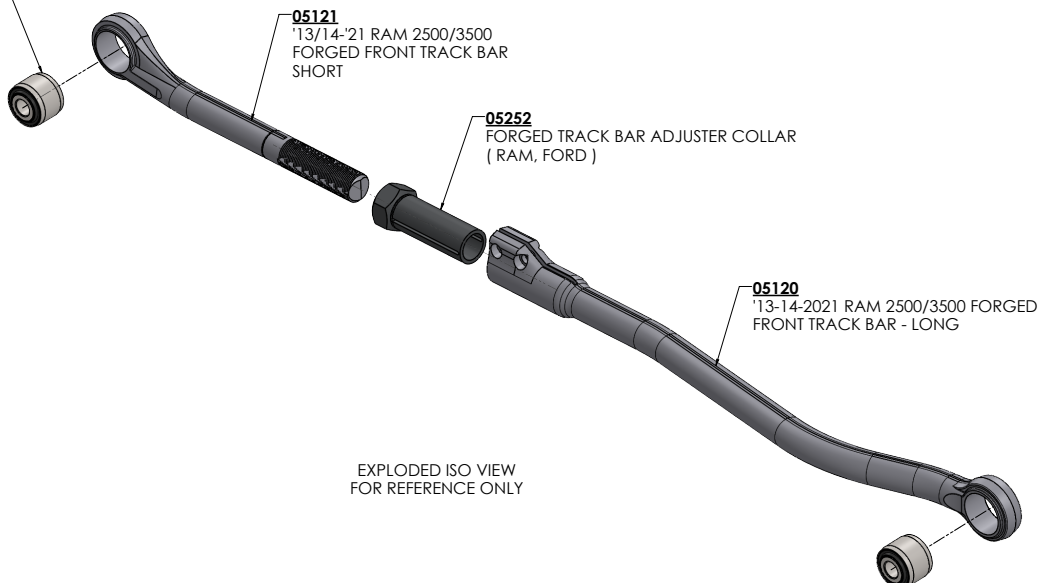

EXPLODED ISO VIEW
FOR REFERENCE ONLY