

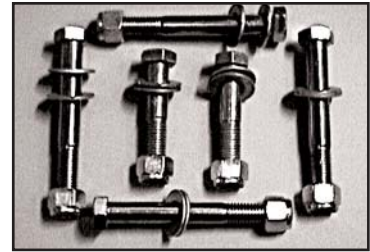

JACK-IT™
THE SUSPENSION EXPERTS



This photo is not necessarily an actual photo of your spring eye bolt kit. Lengths and quantity may differ.

SPRING EYE BOLT KIT

For bolt kit numbers: JAC 1012 / 1013 / 1014 // 1016 / 1018 / 1028 / 1029 / 1046

1. Raise vehicle and support it by the frame. Make sure the vehicle is in park and the jack and stands you are using are rated to support the vehicle you are lifting. Failure to use appropriate equipment and proper safety precautions could result in serious injury or death
2. Place a jack or jack stand underneath the axle to support the weight of the axle once the bolts are removed.
3. Remove U-bolt (#1 in diagram A) from the spring you are working on -- replace bolts one spring at a time.
4. Remove front spring eyebolt (2# in diagram A).
5. Remove rear shackle bolt (#4 in diagram A).

You should now be able to remove the spring from the vehicle and the rear shackle should still be attached to the spring.

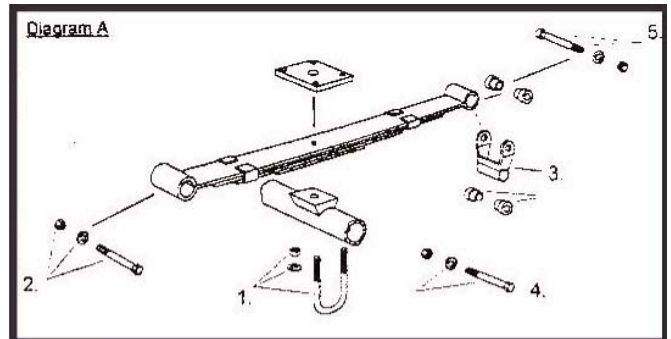

6. Remove and replace the bolt that holds the shackle to the spring. When you replace the bolt, be sure it faces the same direction as it did stock. Most bolt cannot be pointing toward the frame. **if you install this bolt backwards, it will rub the frame during the suspension cycle causing noise and possible damage to the frame-see picture below. Notice the groove that has been gouged into the mounting plate.
7. Put the spring back on the vehicle using the new spring bolts, washers, and nuts provided. You should have two (2) washers per bolt. The washers should be installed on either side fo the spring eyes.
8. Tighten the bolts to 40 ft.lbs. If you over-tighten the shackle will bind and cause the truck to ride poorly.
9. As you are doing this install and once the job is complete, check to be sure bolts are not interfering with brake lines or fuel lines and that these lines have plenty of clearance of safe operation