

Set # 2-4109,2-4110,2-4111,2-4112



1131 VIA CALLEJON, SAN CLEMENTE, CA 92673

©2011 Energy Suspension. All rights reserved.
May not be reproduced, in any form, or by any means,
without the written consent of Energy Suspension.

Removal

Spray all nuts to be removed generously with your favorite rust buster.

Note: When disassembling, note the quantity and positions of any shims that may have been inserted for body alignment. These shims will have to be reused to insure proper body alignment.

Remember: Only raise body high enough to remove & replace mounts. Always watch the fan shroud for sufficient clearance when raising the body. When jacking the body use a long enough 2X4 or 4X4 for maximum support. Never put jack directly on body panels.

Install mounts one side at a time with bolts on other side loosened only.

Retorque to factory specs.

PART #	DESCRIPTION	2.4109	2.4110	2.4111	2.4112
15.03.14.39	WASHER	24	24	16	16
15.03.69.39	WASHER	24	24	16	16
15.08.22.39	PLATE	12	12	8	8
15.05.13.39	BOLT	24	24	16	16
15.05.89.39	BOLT	2		2	
15.05.93.39	BOLT 1" LIFT		12		8
15.07.01.40	L/NUT	24	24	16	16
15.10.504.39	SLEEVE	12		8	
15.10.36.39	SLEEVE 1" LIFT		12		8
4301	TOP BUSHING	12		8	
4313	TOP BUSHING 1" LIFT		12		8
4137	BOTTOM BUSHING	12	12	8	8
	POSITIONS	1-6	1-6	1,2,3,6	1,2,3,6

1. You will need to remove the grill, open your hood and then using a phillips screwdriver, loosen the plastic retaining screws securing the top of your grille to your JK.
2. You may find that a majority of these plastic screws simply turn in place. If this is the case, use a flathead screwdriver to help pry them up and out of their holes.
3. Once loose, the entire plastic screw and expansion sleeve should pull up and out of their mounting holes.
4. Carefully pull your grille forward to separate the lower trim tabs from their mounting slots.
5. Lean your grille forward a bit to gain access to the indicator lights. Then, take the wiring harness plug and pull the red locking tab back.
6. Squeeze the wiring harness plug and pull it out of your indicator light socket.
7. Pull the grille completely off your Jeep and set it someplace safe.
8. Go to the driver side and find your O2 sensor wiring harness which is located below the brake master cylinder.
9. Slide the wiring harness plug off the mounting tab. This is done to provide enough slack for the wiring harness to move when you jack the body up.
10. Loosen but do not remove all 8 or 12, 18mm bolts on the body mounts.
11. Then remove all 16mm nuts on all body mounts.
12. Work on one side at a time and remove the 18mm bolts. Then, using a pry bar, separate the bolt and washer from the body mount.
13. Stack cut lengths of 2x4 on top of a floor jack, position them under the body and just behind the pinch seam.
14. Slowly lift the body up off the driver side frame rail and go just high enough where you can remove the forward most body mount.
15. With the body raised up a bit, you should be able to remove the forward most body mount on the driver side with ease and remove the rest of the body mounts. The 2 door has 8 mounts and the 4 door has 12 mounts total.
16. Install the new mounts on this side on the stock mounts (you will get 2 new bolts for the front position in the kit and reuse the rest of the bolts from the original hardware. In the 1" lift kit you will get all new bolts.) with all hardware in place and snug, let the jack down and repeat this process on the other side.
17. Once other side is complete and jack removed torque down the hardware. 16mm torque to 40 ft. lbs, 18mm torque to 80 ft. lbs.
18. Then reassemble the grill in reverse order.

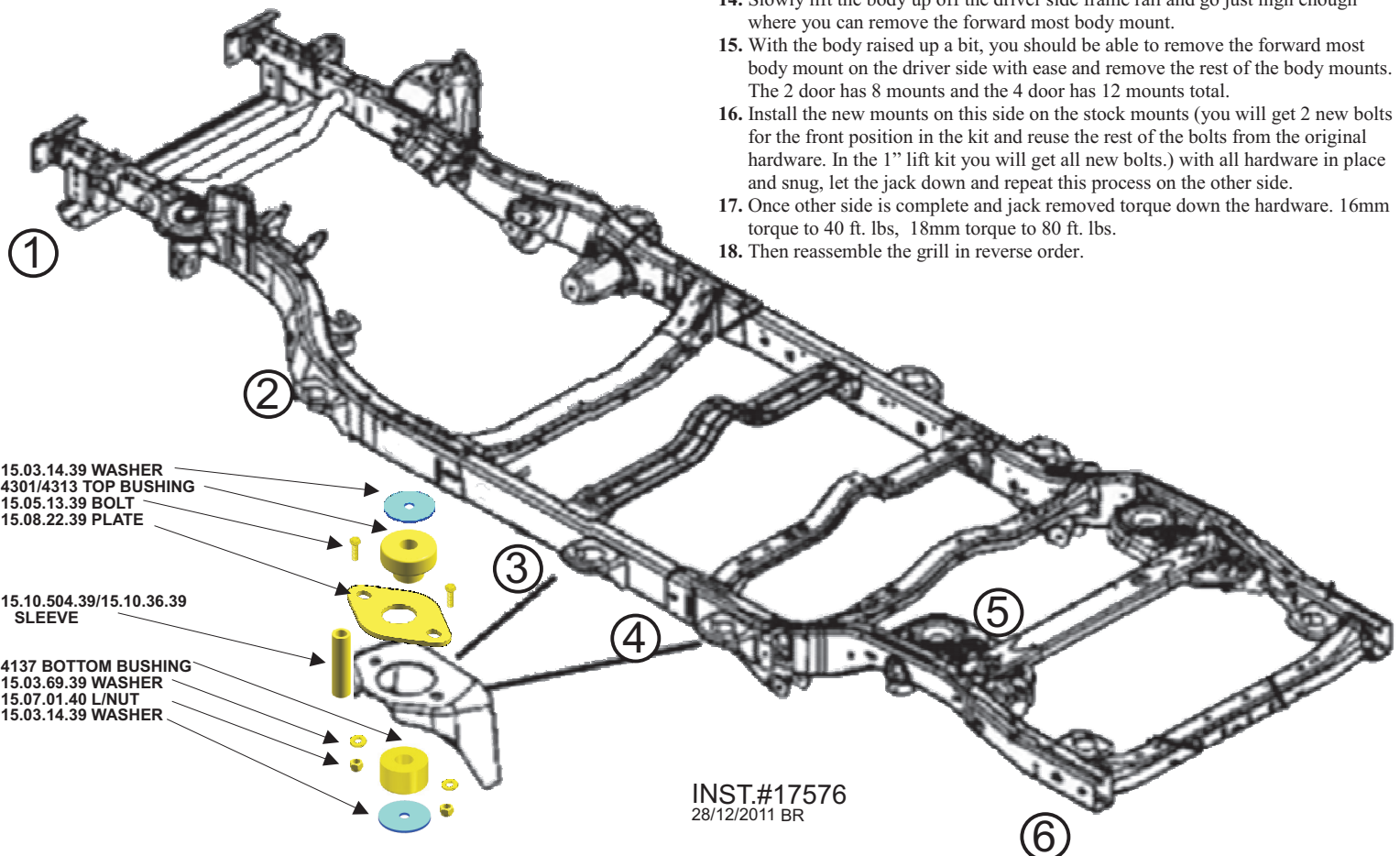

INST.#17576
28/12/2011 BR