

INSTALLATION INSTRUCTIONS AND PARTS LIST

FOR MOUNTING 209923 (STAINLESS STEEL) SIDE ENTRY STEPS ON:
1999 AND NEWER FORD SUPER DUTY CREW CAB PICKUPS

1. READ INSTRUCTIONS COMPLETELY AND CHECK TO MAKE SURE THAT ALL REQUIRED PARTS (LISTED ON SERVICE PARTS LIST) ARE ON HAND BEFORE STARTING THE INSTALLATION.
2. PEEL AWAY THE PROTECTIVE VINYL COVERING AND CLEAN THE TOP OF EACH STEP PLATE TO REMOVE ANY VINYL COVERING RESIDUE. RUBBING ALCOHOL OR A GOOD GLASS CLEANER SUCH AS WINDEX IS SUGGESTED.
3. EXISTING MOUNTING HOLE PATTERNS ARE LOCATED ON THE INTERIOR WALL AND PINCH WELD OF THE ROCKER PANEL. THESE MOUNTING HOLE PATTERNS MUST BE USED FOR THIS INSTALLATION PER THE FOLLOWING INSTRUCTIONS.
 - 3.1 ON ALL MOUNTING HOLE PATTERNS, INSTALL 5/16" MULTI THREAD U-NUTS (ITEM #14) INTO THE TOP REAR HOLES. INSTALL THESE NUTS SO THAT THE THREADS ARE TO THE INSIDE OF THE ROCKER PANEL. (THIS IS DONE BY INSERTING THE THREADED HALF OF THE U-NUT THRU THE 3/4" X 1-1/2" RECTANGULAR SLOT AND SLIDING THE U-NUT TOWARDS THE REAR UNTIL THE NUT SEATS IN THE ROUND HOLE.)
 - 3.2 ON THE PINCH WELD MOUNTING HOLES, USE THE REAR HOLE OF THE FRONT PATTERN AND THE FRONT HOLE ON ALL REMAINING PATTERNS. INSTALL THE 5/16" U-NUTS SO THAT THE THREADS ARE TO THE OUTBOARD SIDE OF THE PINCH WELD.
4. POSITION THE SIDE ENTRY STEP ASSEMBLY SNUG UP UNDER THE ROCKER PANEL SO THAT THE HOLES IN THE MOUNTING BRACES (ITEM #5 & #6) MATCH THE U-NUTS IN THE HOLES LISTED ABOVE. INSERT 5/16" X 7/8" BOLTS (ITEM #13) AND 5/16" FLAT WASHERS (ITEM #15) THRU THE BRACE AND INTO THE U-NUTS. (TORQUE THESE BOLTS TO 19 LB FT.)

ITEM	PART NO.	QTY	DESCRIPTION
1	549280	1	STEP PLATE-RH, FORD, SUPER DUTY, CREW CAB
2	549282	1	STEP PLATE-LH, FORD, SUPER DUTY, CREW CAB
3	104250	2	END CAP-RH FRONT/LH REAR
4	104251	2	END CAP-LH FRONT/RH REAR
5	549233	2	BRACE-SPRT, FORD, SUPER DUTY, RH/LH, FRONT
6	549235	6	BRACE-SPRT, FORD, SUPER DUTY, RH/LH, CNTR/REAR
7	102600	4	PAD-MLD, STEP PLATE, 20.00" LG
8	104255	2	TRIM-SEAL, EXTRN, 80.50" LG
9	104257	12	NUT-HEX, SINGLE SELF THDG, CAP WASHER, 1/4"
10	104258	12	BOLT-CARRIAGE, SST, #10-24 X 3/4"
11	104259	4	BOLT-CARRIAGE, CLP HD, SST, #10-24 X 3/4"
12	104261	16	NUT-SERR FLANGE, HEX, SST, #10-24
13	104281	16	SCREW-HEX HEAD CAP, 5/16-18 X 7/8"
14	104264	16	NUT-U, MULTI THD, 5/16-18
15	100034	16	WASHER-FLAT, 5/16"

SERVICE PARTS LIST

MODEL NO. - 209923

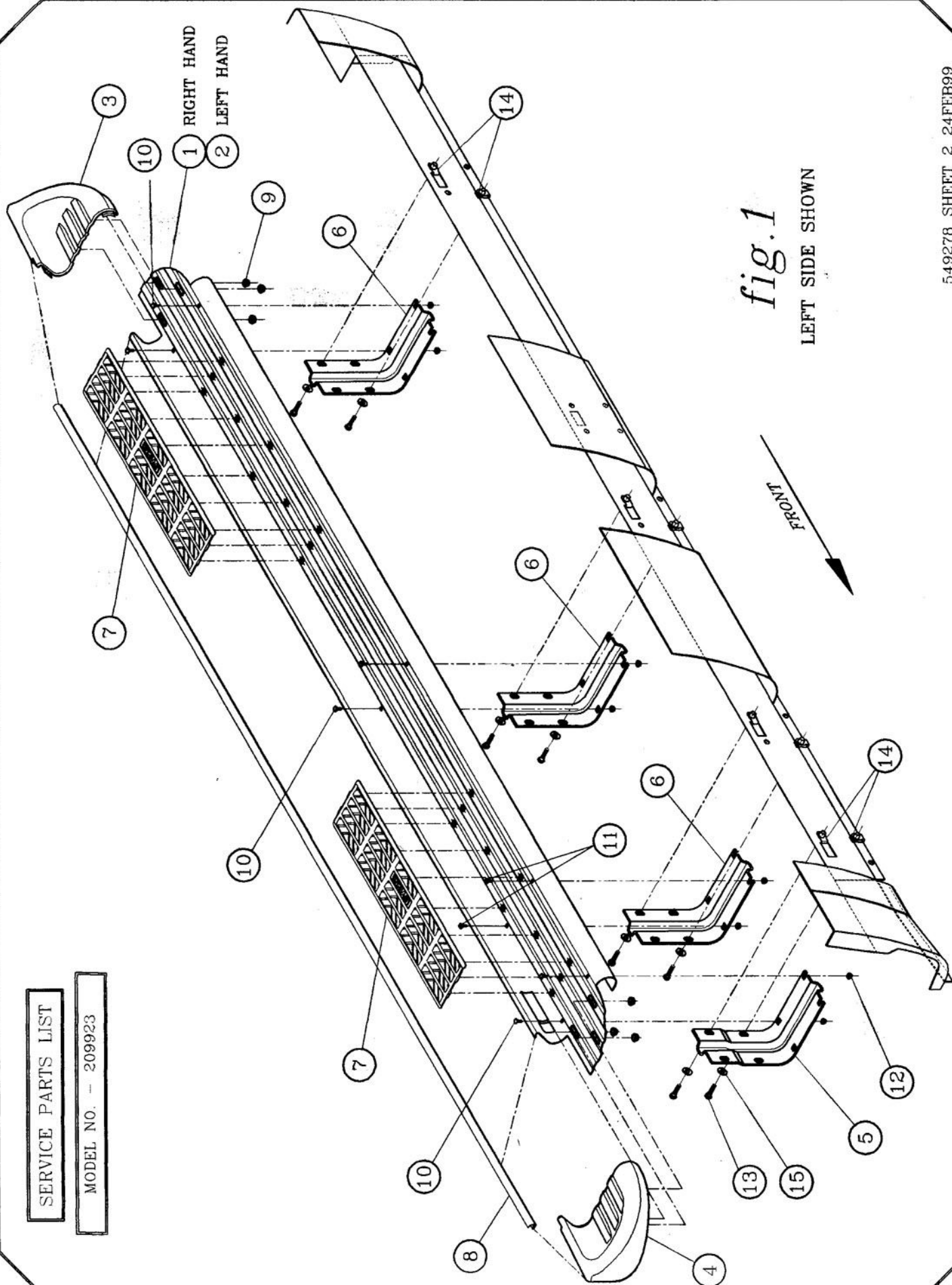

fig.1
LEFT SIDE SHOWN